

Product description	M12 Male panel mount connector, Contacts: 5, unshielded, SMT, IP67, for SMT
Area	M12-A series 763
Part no.	99 3441 351 05

Illustration

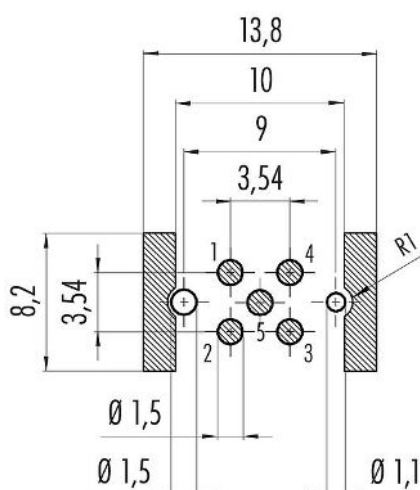

Conductor layout



Scale drawing

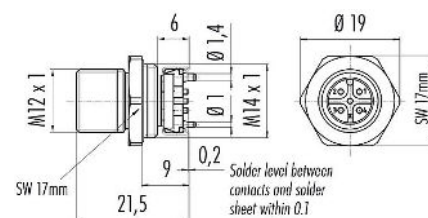

Contact arrangement (Plug-in side)

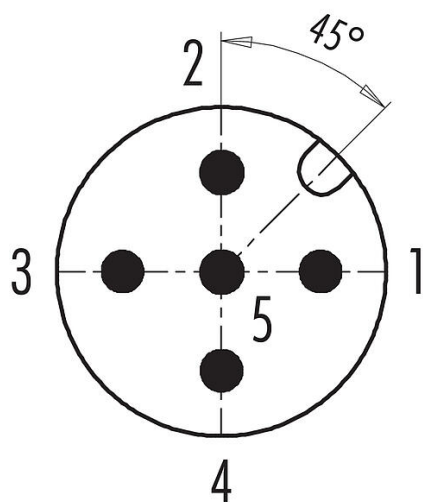

You can find the assembly instructions on the next page.

Technical data

Product data sheet

Automation technology - Sensors and actuators



Product description	M12 Male panel mount connector, Contacts: 5, unshielded, SMT, IP67, for SMT
-	-
Area	M12-A series 763
Part no.	99 3441 351 05

General features

Part no.	99 3441 351 05
Connector design	Male panel mount connector
Type standard	DIN EN 61076-2-101
Version	Connector pin straight
Connector locking system	screw
Termination	SMT
Degree of protection	IP67
Temperature range from/to	-40 °C / 85 °C
Mechanical operation	> 100 Mating cycles
Installation height	9
Weight (g)	9.31
Customs tariff number	85369010
Country of Origin	DE

Electrical parameters

Rated voltage	60 V
Rated impulse voltage	1500 V
Rated current	4.0 A
Insulation resistance	> 10 ¹⁰ Ω
Pollution degree	3
Insulating material group	III
EMC compliance	unshielded

Material

Housing material	CuZn (Brass nickel plated)
Contact body material	LCP
Contact material	CuZn (brass)
Contact plating	Au (gold)
REACH SVHC	CAS 7439-92-1 (Lead)
SCIP number	08cb4d2e-9cd7-4d43-b66e-b23bedd57ab0

Product description	M12 Male panel mount connector, Contacts: 5, unshielded, SMT, IP67, for SMT
-	-
Area	M12-A series 763
Part no.	99 3441 351 05

Assembly instructions

1. Solder the SMT contact insert to the PCB using a suitable soldering method.
2. Fasten panel mount connector sleeve in panel cut out.
3. Guide SMT contact insert through the panel mount connector sleeve.
4. Only for female parts:
Thread the o-ring onto the contact carrier and push it to the bottom with a suitable tool (possibly SMT male insert).

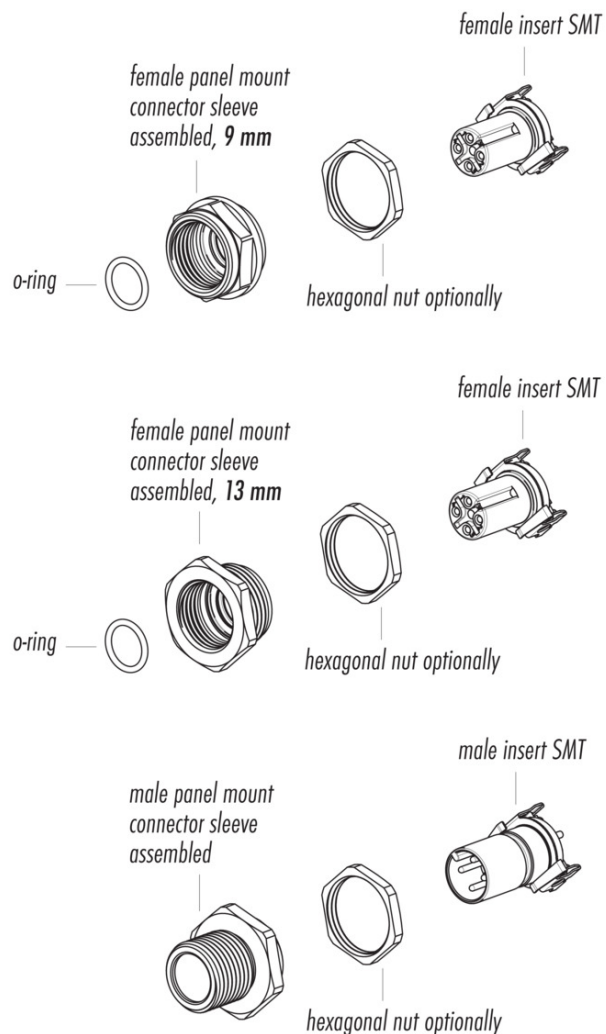

Product description	M12 Male panel mount connector, Contacts: 5, unshielded, SMT, IP67, for SMT
-	-
Area	M12-A series 763
Part no.	99 3441 351 05

General Disclaim Notice

The connector must not be plugged or unplugged under load. Non-observance and improper use can result in personal injury.

The connectors have been developed for applications in plant engineering, control and electrical equipment construction. The user is responsible for checking whether the connectors can also be used in other areas of application.

The user must take suitable safety precautions to ensure that the connector cannot be accidentally disconnected.

Plug connectors with enclosure protection IP67 and IP68 are not suitable for use under water. For further information on the IP protection classes, please refer to the "Technical Information" download centre.