

DASH NO.

M CODE

MADE FROM

GSD

M39012/26-0101

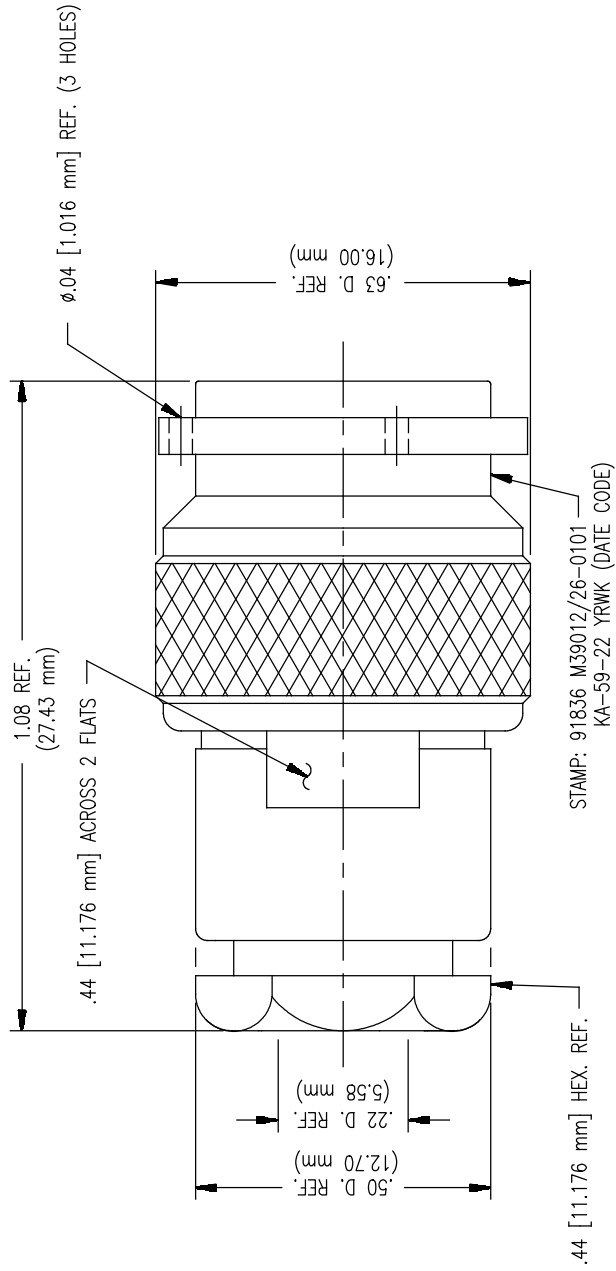

NOTES:

1. FOR USE RG-58, 142, 223, & 400/U CABLE.
2. FOR CABLING INSTRUCTIONS SEE 3-70.
3. INTERFACE PER MIL-STD-348, FIG. 313-1.
4. MATERIALS:
INSULATORS: PTFE, ASTM-D1710
GASKETS: SIL. RUB. A-A-59588
C-RING: PHOS. BRONZE, ASTM-B135
OUTER CONTACT: BER. COP., ASTM-B196
ALL OTHER PARTS: BRASS, ASTM-B16
5. FINISHES:
CENTER CONTACT: HARD GOLD PLATE PER ASTM-B488
ALL OTHER METAL PARTS: SILVER PLATE PER ASTM-B700
6. ELECTRICAL CHARACTERISTICS:
NOMINAL IMPEDANCE: 50 OHMS
VOLTAGE RATING: 500 VRMS
FREQUENCY RANGE: DC TO 11 GHz

REVISIONS

ISSUE

CHANGES

13 CN 32498 C
KH 09/21/90

14 CN 38289 C
REDRAWN
TML 05/10/01

15 CN 38846 E
BDH 05/09/03

16 CN 39708 C
PMC 11/20/06

17 CN 39744 C
HVN 01/02/07

V ER063441
CY 08/17/16

KA-59-22 SD

THIS DRAWING, THE DESIGNS AND IDEAS EMBODIED
HEREIN, DEVELOPED BY OR FOR THE PROPERTY OF
WINCHESTER ELECTRONICS CORPORATION AND SHALL NOT BE EMPLOYED,
COPIED, OR DISCLOSED TO ANYONE, IN ANY
MANNER WITHOUT THE CONSENT OF WINCHESTER
ELECTRONICS CORPORATION.

SCALE 4:1

APPROX. SURFACE AREA

KA-59-22

USED ON

REF:

PLUG, TNC

DRAWN JHP DATE 03/21/77

DESIGN DATE

APPR. SAJ DATE 04/14/71



Winchester Electronics
Corporation
199 Park Road Ext. Suite 104
Middletown,
Connecticut 06762

M39012/26-0101

GSD