

Panel Jack Receptacles—Square Flange

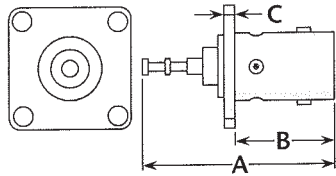

Figure 1
(Turret contact)

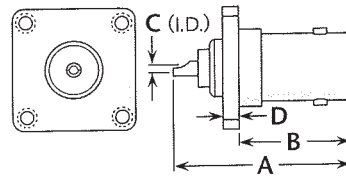

Figure 2
(Solder pot contact)

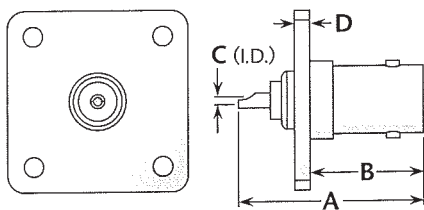

Figure 3
(Solder pot contact, 1" square flange,
interchangeable with type N standard flange size)

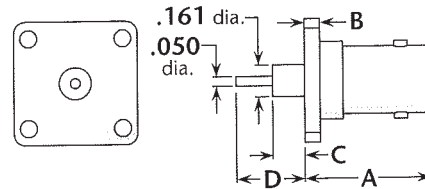

Figure 4
(Post contact)

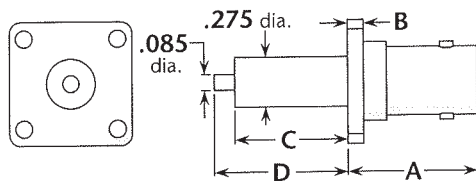

Figure 5
(Post contact)

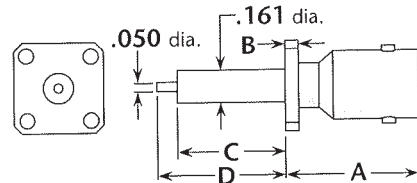

Figure 6
(Post contact, 1/2" square flange,
interchangeable with SMA standard flange size)

Figure	Dimensions				Mounting Figure	Plating		Delta P/N
	A	B	C	D		Body	Contact	
1	1.06	.55	.050	—	18	Nickel	Silver (C)	UG-185/U
2	1.06	.63	.062	.090	07	Nickel	Silver (C)	UG-290A/U
2	1.06	.63	.043	.090	12	Nickel	Silver (C)	UG-447/U
2	1.06	.63	.062	.090	07	Silver	Gold (C)	M39012/22-0001
2	1.06	.63	.062	.090	09	Nickel	Silver (C)	1013-000-N090
2	1.06	.63	.062	.090	10	Nickel	Silver (C)	1013-000-N100
2	1.06	.63	.062	.090	18	Nickel	Gold (C)	1013-000-N180
2	1.00	.75	.062	.080	18 [§]	Nickel	Gold (C)	1013-000-F181**
3	1.06	.63	.062	.080	33	Nickel	Silver (C)	1013-000-N330
4	.715	.090	.175	.375	09	Nickel	Silver (C)	1058-000-N091
5	.750	.080	.590	.705	18 [§]	Nickel	Gold (C)*	1058-000-N181-1
6	.750	.080	.590	.705	05	Nickel	Gold (C)	1058-000-N051

(C) in contact plating column indicates captive contact. • *Indicates epoxy-captivated contact. • **Insulator flush with rear of flange.

[§]Flange #18 except with .125 dia. mounting holes. • See page 6 for alternate body plating information.

See page 203 for mounting dimensions. • All items are available with other flange sizes and contact configurations.