

Panel Jack—Military Clamp for Flexible Cable

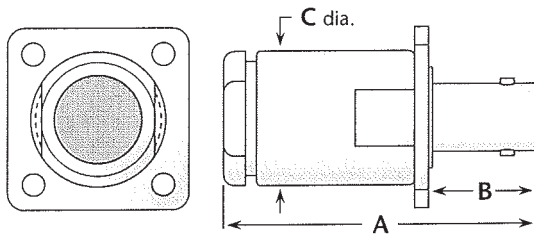

Figure 1

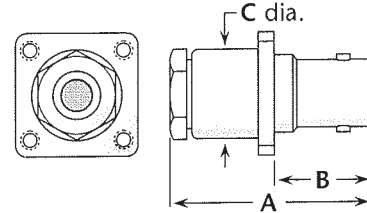

Figure 2

Cable Group	Fig.	Dimensions			Mounting Figure	Plating		Delta P/N	Assembly Procedure/Trim Code
		A	B	C		Body	Contact		
1	1	1.75	.63	.75	33	Nickel	Silver	1011-001-N330	A/20
2, 3	1	1.75	.63	.75	33	Nickel	Silver	1011-004-N330	A/20
5, 6	2	1.16	.55	.50	07	Nickel	Silver	UG-291C/U	A/17
5, 6	2	1.16	.55	.50	07	Silver	Gold (C)	M39012/18-0102	A/17
5, 6	2	1.16	.55	.50	07	Nickel	Gold (C)	1011-015-N071	A/17
7	2	1.16	.55	.50	07	Nickel	Silver	UG-262C/U	A/17
7	2	1.16	.55	.50	07	Silver	Gold (C)	M39012/18-0101	A/17
7	2	1.16	.55	.50	07	Nickel	Silver (C)	1011-021-N071	A/17
8A	2	1.16	.55	.50	07	Silver	Gold (C)	M39012/18-0103	A/17
9	2	1.16	.55	.50	07	Nickel	Silver	1011-036-N070	A/18
9	2	1.16	.55	.50	07	Nickel	Silver (C)	1011-036-N071	A/38
9	2	1.16	.55	.50	07	Silver	Gold (C)	M39012/18-0220	A/38
11	2	1.16	.55	.50	07	Nickel	Silver	1011-038-N070	A/18
11	2	1.16	.55	.50	07	Nickel	Silver (C)	1011-038-N071	A/18
22	2	1.16	.55	.50	07	Silver	Gold (C)	M39012/18-0118	A/17
23	2	1.16	.55	.50	07	Silver	Gold (C)	M39012/18-0111	A/17

Panel Jack—Solder-Clamp for Semi-Rigid Cable

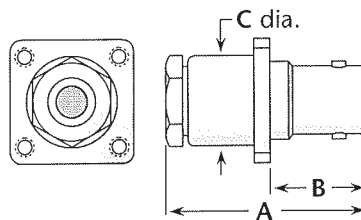

Figure 1

Cable Group	Fig.	Dimensions			Mounting Figure	Plating		Delta P/N	Assembly Procedure/Trim Code
		A	B	C		Body	Contact		
13	1	1.16	.55	.50	07	Nickel*	Gold	1011-031-N073	F/08
14	1	1.16	.55	.50	07	Nickel*	Gold	1011-025-N073	F/07

* Solder ferrule is gold plated.

See page 204 for cable groups. • Assembly procedures start on page 205. • See page 203 for mounting dimensions. (C) in contact plating column indicates captive contact. • See page 6 for alternate body plating information.