

## M39012/32—TNC Panel Receptacle

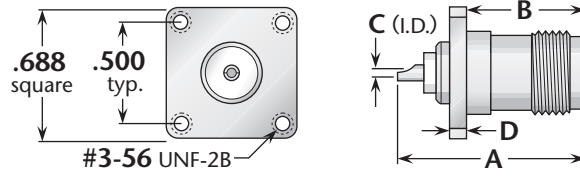

**Figure 1**

M39012 P/N	Figure	Dimensions				Maximum Panel	Plating	
		A	B	C	D		Body	Contact
<b>M39012/32-0001</b>	1	1.06	.63	.062	.090	.125	Silver	Gold (C)

## M39012/34—TNC Bulkhead Receptacle (Hermetically Sealed)

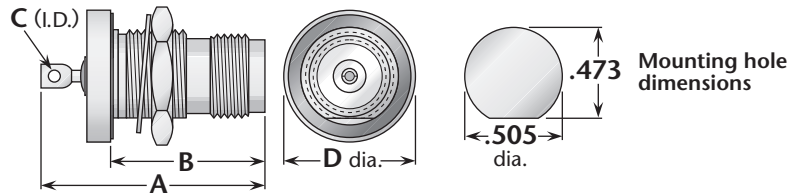

**Figure 1  
(Rear mount)**

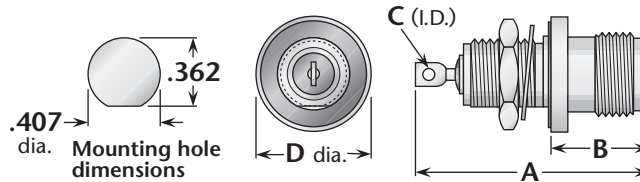

**Figure 2  
(Front Mount)**

M39012 P/N	Figure	Dimensions				Maximum Panel	Plating	
		A	B	C	D		Body	Contact
<b>M39012/34-0001</b>	1	1.20	.83	.062	.687	.25	Silver	Gold (C)
<b>M39012/34-0002</b>	2	1.20	.52	.062	.594	.25	Silver	Gold (C)

(C) indicates captive contact.