

M39012/29—TNC Panel Jack

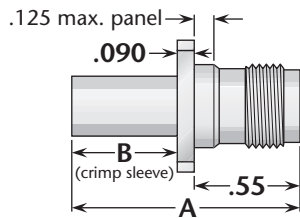

Figure 1

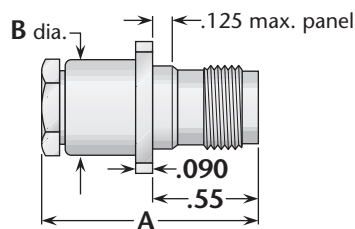
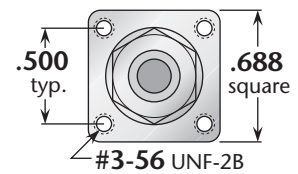

Figure 2



Flange dimensions

M39012 P/N	Category	Cable Group	Figure	Dimensions		Plating		Assembly Procedure/ Trim Code
				A	B	Body	Contact	
M39012/29-0010	C	VIA	1	1.17	.50	Silver	Gold (C)	B / 19
M39012/29-0011	C	VIB	1	1.17	.50	Silver	Gold (C)	B / 19
M39012/29-0012	C	VIIA	1	1.43	.50	Silver	Gold (C)	B / 19
M39012/29-0013	C	IV	1	1.17	.50	Silver	Gold (C)	B / 19
M39012/29-0014	C	VIIIB	1	1.17	.50	Silver	Gold (C)	B / 19
M39012/29-0018	A	II	2	1.16	.50	Silver	Gold (C)	A / 17
M39012/29-0022	C	IIA	1	1.13	.44	Silver	Gold (C)	Contact Factory
M39012/29-0101	A	VI	2	1.16	.50	Silver	Gold (C)	A / 17
M39012/29-0102	A	VII	2	1.16	.50	Silver	Gold (C)	A / 17
M39012/29-0103	A	IV	2	1.16	.50	Silver	Gold (C)	A / 17

M39012/31—TNC Bulkhead Receptacle

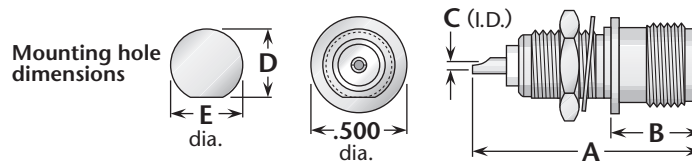

Figure 1

M39012 P/N	Figure	Dimensions					Maximum Panel	Plating	
		A	B	C	D	E		Body	Contact
M39012/31-0001	1	1.06	.47	.062	.410	.442	.13	Silver	Gold (C)
M39012/31-0002	1	1.19	.47	.062	.348	.380	.25	Silver	Gold (C)

See page 185 for cable groups and category definitions. • Assembly procedures start on page 205. • (C) indicates captive contact.